



# DRYWALL AND HOLLOW CAVITY ANCHORS



# DRYWALL AND HOLLOW CAVITY ANCHORS

## Toggle Bolts

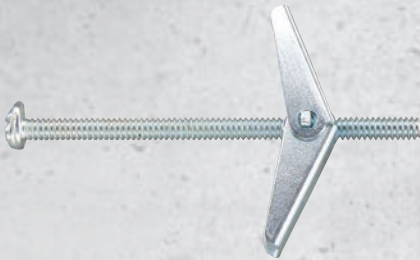

The Aerosmith Toggle Bolt is specifically designed to be used in drywall/wallboard and other hollow base materials where expansion anchors typically do not work or perform well. The toggle bolt is a two component system consisting of a machine bolt in either a round, mushroom, or flat head and a spring wing. Sizes range from 1/8" to 1/2" in diameter. A variety of different lengths can be used, depending on the application and thickness of the material, before entering the hollow cavity.

## Nylon & Zinc EZ Zip Drywall Anchors



Aerosmith's EZ Zip Drywall/Wallboard Anchor is a one piece self-drilling anchor which is manufactured and available in both engineered nylon and zinc alloy. The EZ Zip is specifically designed for use in drywall/wallboard and can be used with either a number #6 or a number #8 sheet metal screw. Anchors can also be ordered with or without screws or in an easy to use EZ Zip kit version. It is intended for use in drywall/wallboard thicknesses of 3/8" to 1".

## Nylon Drywall Toggle

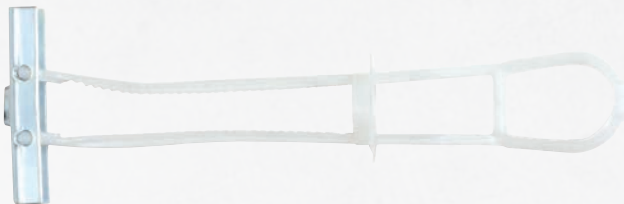

The Aerosmith Nylon Toggle is a one-piece pre-assembled anchor that can be used in hollow wallboard or hollow block applications. The anchor consists of a carbon steel wing and an engineered plastic strap. Simply fold the wing perpendicular to the strap, push wing through the proper pre-drilled hole, pull back on the strap, and slide the plastic disc against the front of the wall. Snap off the remaining nylon, put fixture in place and screw into the wing using a machine bolt of the proper diameter. By folding the wing perpendicular with the strap, this allows the anchor to be installed into smaller holes than conventional spring wing toggles. Nylon toggles are available in 3/16", 1/4", 3/8", and 1/2" diameters.

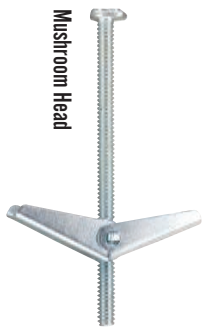

Mushroom Head

# Toggle Bolts

The Aerosmith Toggle Bolt is specifically designed to be used in drywall/wallboard and other hollow base materials where expansion anchors typically do not work or perform well. The toggle bolt is a two component system consisting of a machine bolt in either a round, mushroom, or flat head and a spring wing. Sizes range from 1/8" to 1/2" in diameter. A variety of different lengths can be used, depending on the application and thickness of the material, before entering the hollow cavity.

## APPLICATIONS:

- Attachment of insulation
- Suspended ceiling hangers
- Lighting
- TV brackets into hollow base materials
- Picture hanging
- Railings

## FEATURES AND BENEFITS:

- Adjustable for various wall thicknesses
- Fast and easy installation and removal
- Available in a variety of head styles
- Product made from carbon steel
- Clamps the back of the base material providing resistance.

## BASE MATERIAL:

- Drywall
- Hollow block

## ANCHOR COMPONENT MATERIALS:

Carbon Steel - Zinc plated

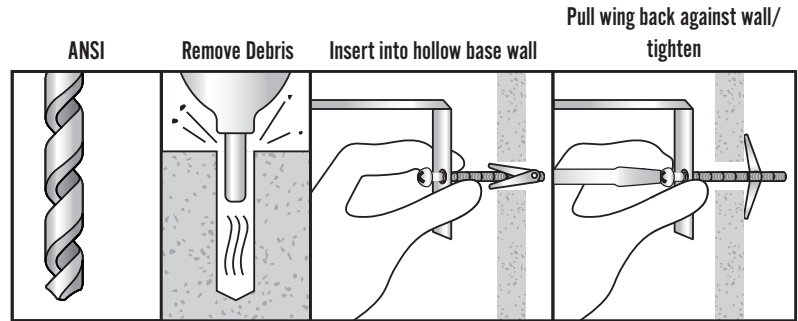

Round Head

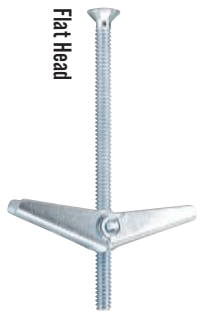

Flat Head



Wing

Part ID	Product Name	Description	Overall Length	Diameter	ANSI Drill Diameter	Box Quantity	Carton Quantity
TGMH182	Toggle Bolt Mushroom Head	1/8" X 2"	2"	1/8"	3/8"	50	500
TGMH183	Toggle Bolt Mushroom Head	1/8" X 3"	3"	1/8"	3/8"	50	500
TGMH184	Toggle Bolt Mushroom Head	1/8" X 4"	4"	1/8"	3/8"	50	500
TGMH3163	Toggle Bolt Mushroom Head	3/16" X 3"	3"	3/16"	1/2"	50	500
TGMH3164	Toggle Bolt Mushroom Head	3/16" X 4"	4"	3/16"	1/2"	50	500
TGMH143	Toggle Bolt Mushroom Head	1/4" X 3"	3"	1/4"	5/8"	50	500
TGMH144	Toggle Bolt Mushroom Head	1/4" X 4"	4"	1/4"	5/8"	50	500
TGRH182	Toggle Bolt Round Head	1/8" X 2"	2"	1/8"	3/8"	50	500
TGRH183	Toggle Bolt Round Head	1/8" X 3"	3"	1/8"	3/8"	50	500
TGRH184	Toggle Bolt Round Head	1/8" X 4"	4"	1/8"	3/8"	50	500
TGRH3163	Toggle Bolt Round Head	3/16" X 3"	3"	3/16"	1/2"	50	500
TGRH3164	Toggle Bolt Round Head	3/16" X 4"	4"	3/16"	1/2"	50	500
TGRH3165	Toggle Bolt Round Head	3/16" X 5"	5"	3/16"	1/2"	50	500
TGRH3166	Toggle Bolt Round Head	3/16" X 6"	6"	3/16"	1/2"	50	500
TGRH143	Toggle Bolt Round Head	1/4" X 3"	3"	1/4"	5/8"	50	500
TGRH144	Toggle Bolt Round Head	1/4" X 4"	4"	1/4"	5/8"	50	500
TGRH145	Toggle Bolt Round Head	1/4" X 5"	5"	1/4"	5/8"	50	500
TGRH146	Toggle Bolt Round Head	1/4" X 6"	6"	1/4"	5/8"	50	500
TGRH383	Toggle Bolt Round Head	3/8" X 3"	3"	3/8"	7/8"	25	250
TGRH384	Toggle Bolt Round Head	3/8" X 4"	4"	3/8"	7/8"	25	250
TGRH385	Toggle Bolt Round Head	3/8" X 5"	5"	3/8"	7/8"	25	125
TGRH386	Toggle Bolt Round Head	3/8" X 6"	6"	3/8"	7/8"	25	125
TGFH183	Toggle Bolt Flat Head	1/8" X 3"	3"	1/8"	3/8"	50	500
TGFH3164	Toggle Bolt Flat Head	3/16" X 4"	4"	3/16"	1/2"	50	500
TGFH143	Toggle Bolt Flat Head	1/4" X 3"	3"	1/4"	5/8"	50	500
TGFH144	Toggle Bolt Flat Head	1/4" X 4"	4"	1/4"	5/8"	50	500
TGW18	Toggle Wings	1/8"	N/A	N/A	3/8"	100	500
TGW316	Toggle Wings	3/16"	N/A	N/A	1/2"	100	1000
TGW14	Toggle Wings	1/4"	N/A	N/A	5/8"	100	1000
TGW38	Toggle Wings	3/8"	N/A	N/A	7/8"	50	500



# EZ Zip Drywall Anchors

Aerosmith's EZ Zip Drywall Anchor is a one-piece self-drilling anchor which is manufactured and available in both engineered nylon and zinc alloy. It is specifically designed for use in dry wall and can be used in wallboard from 3/8" to thickness. Both the nylon and zinc part can be used with a #6 or #8 screw.

## APPLICATIONS:

- Electrical fixtures
- Shelving
- Telephone systems
- Curtain poles
- Interior finishing
- Miscellaneous hardware

## FEATURES AND BENEFITS:

- Fully removable
- No requirement for pre-drilling
- Accurate fixing with tooth design
- Accurate fixing with point design in drywall

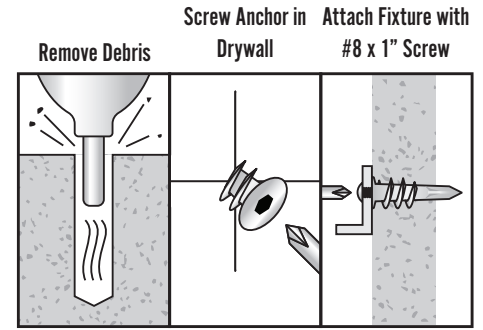

## ANCHOR COMPONENT MATERIALS:

- Engineered Nylon
- Zinc Alloy

## BASE MATERIAL:

- Drywall / Wallboard

Part ID	Description	Wall Thickness	Screw Size	Box Quantity	Carton Quantity
ZPZ381	Zinc Drywall Anchor 3/8" to 1" w/Screw	3/8" - 1"	#8x1"	100	1000
ZPZ381NS	Zinc Drywall Anchor 3/8" to 1" w/o Screw	3/8" - 1"	#8x1"	100	1000
ZPZ381NSB	Zinc Drywall Anchor 3/8" to 1" w/o Screw	3/8" - 1"	#8x1"	5000	5000
ZPZ381K	Zinc Drywall Anchor 3/8" to 1" Kit	3/8" - 1"	#8x1"	1	10
ZPN381	Nylon Drywall Anchor 3/8" to 1" w/ Screw	3/8" to 1"	#8x1"	100	1000
ZPN381NS	Nylon Drywall Anchor 3/8" to 1" w/o Screw	3/8" to 1"	#8x1"	100	1000
ZPN381B	Nylon Drywall Anchor 3/8" to 1" Bulk	3/8" to 1"	#8x1"	5,000	5,000
ZPN381K	Nylon Drywall Anchor 3/8" to 1" Kit	3/8" to 1"	#8x1"	1	10



# Nylon Drywall Toggle

The Aerosmith Nylon Toggle is a one-piece pre-assembled anchor that can be used in hollow wallboard or hollow block applications. The anchor consists of a carbon steel wing and an engineered plastic strap. Simply fold the wing perpendicular to the strap, push wing through the proper pre-drilled hole, pull back on the strap, and slide the plastic disc against the front of the wall. Snap off the remaining nylon, put fixture in place and screw into the wing using a machine bolt of the proper diameter. By folding the wing perpendicular with the strap, this allows the anchor to be installed into smaller holes than conventional spring wing toggles. Nylon toggles are available in 3/16", 1/4", 3/8", and 1/2" diameters.

## APPLICATIONS:

- Towel bars
- Kitchen cabinets
- Bathroom accessories
- Electrical boxes
- Pictures
- Mirrors
- Handrails
- Signage

## FEATURES AND BENEFITS:

- Fully adjustable for different wall thickness
- Quick and easy installation
- Available in 4 diameters
- Wing clamps behind wall
- Can be used in wall thickness up to 2-1/2"

## BASE MATERIAL:

- Drywall
- Hollow block

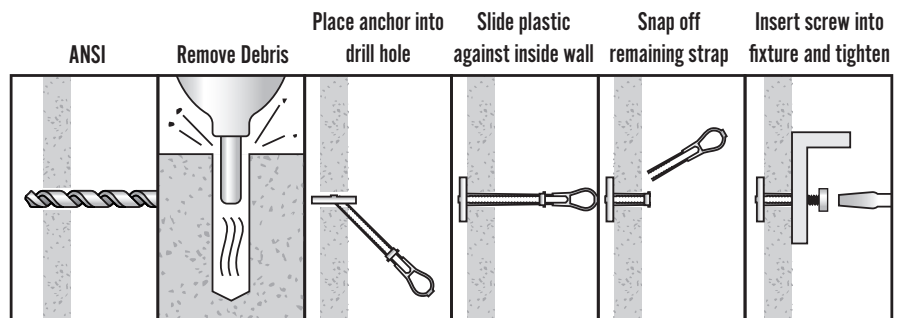

## ANCHOR COMPONENT MATERIALS:

Engineered Plastic with a Carbon Steel Wing

Part ID	Description	ANSI Drill Diameter	Box Quantity	Carton Quantity
STG316	3/16" x 4"	1/2"	50	300
STG14	1/4" x 4"	1/2"	50	300
STG38	3/8" x 4"	3/4"	25	150
STG12	1/2" x 4"	3/4"	25	150