

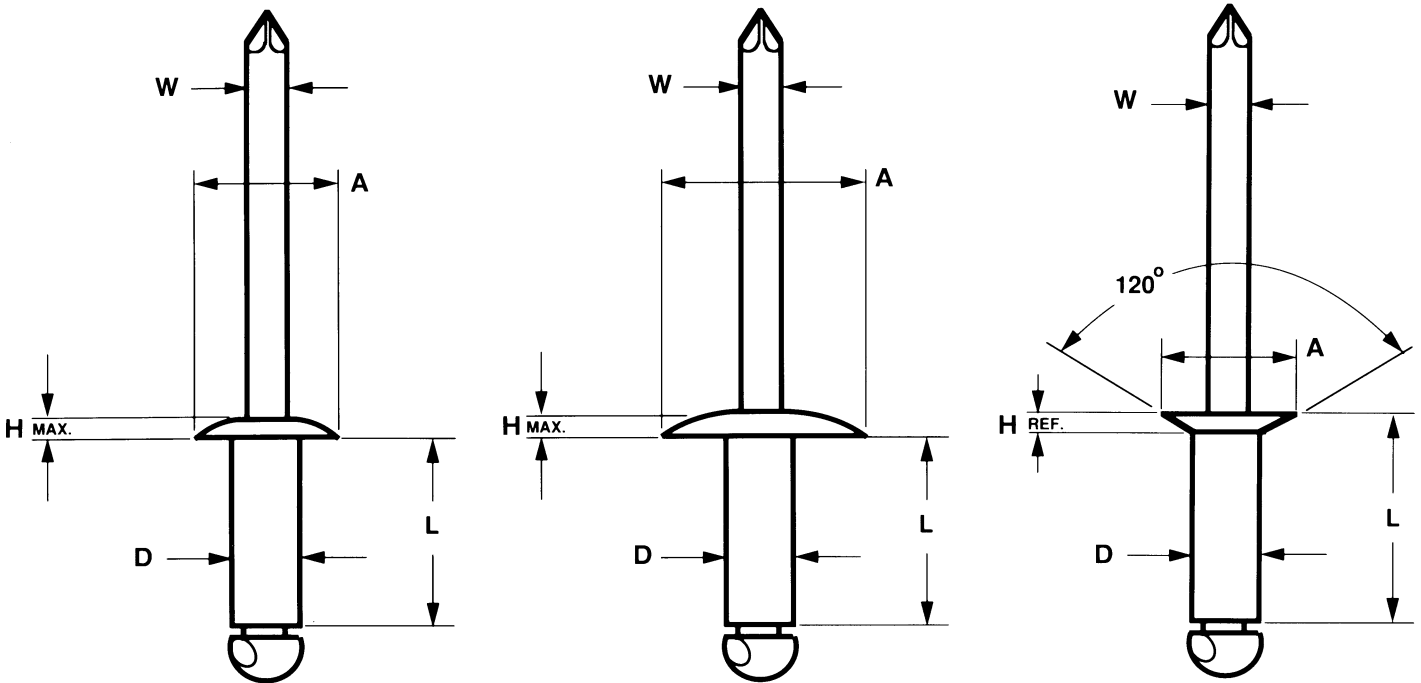

BLIND RIVETS - OPEN END



| Rivet Series Number | Nominal Rivet Size | D Body Diameter | | W Mandrel Diameter | Dome Head | | Large Flange | | Countersunk Head | | Hole Size and Drill Number |
|---------------------|--------------------|-----------------|--------------|--------------------|-------------|--------------------|--------------|--------------------|------------------|--------------------|----------------------------|
| | | Max. | Min. | | A Head Dia. | H Max. Head Height | A Head Dia. | H Max. Head Height | A Head Dia. | H Max. Head Height | |
| | | 3 | 3/32 (2.4mm) | | .096 | .090 | 0.057 | .187 | .032 | .281 | |
| 4 | 1/8 (3.2mm) | .128 | .122 | 0.076 | .250 | .040 | .375 | .065 | .226 | .032 | .129-.133 (#30) |
| 5 | 5/32 (4.0mm) | .159 | .153 | 0.095 | .312 | .050 | .469 | .075 | .281 | .040 | .160-.164 (#20) |
| 6 | 3/16 (4.8mm) | .191 | .183 | 0.114 | .375 | .060 | .625 | .092 | .344 | .050 | .192-.196 (#11) |
| 8 | 1/4 (6.4mm) | .255 | .246 | 0.151 | .500 | .080 | .750 | .107 | .468 | .071 | .257-.261 (F) |

Length varies with each grip length, see pages 16-17
 Values in blue are metric.

PART NUMBERING

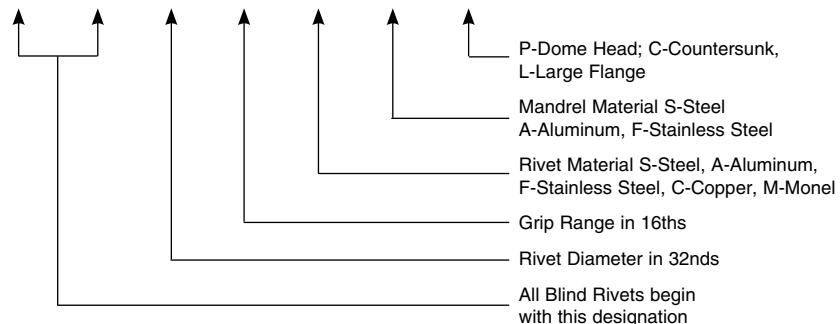
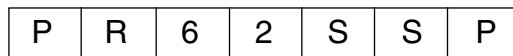



BLIND RIVETS - OPEN END

| Rivet Diameter | G Grip Range | L Rivet Lengths Max | Aluminum Rivet Aluminum Mandrel IFI Grade 11 | | | | | Aluminum Rivet Steel Mandrel IFI Grade 19 | | | | | Steel Rivet Steel Mandrel IFI Grade 30 | | | | |
|-----------------|--------------------------|---------------------|--|--------------|---------------|-----------|---------------|---|--------------|---------------|-----------|---------------|--|--------------|---------------|-----------|---------------|
| | | | Dome Head | Large Flange | Countsk. Head | S H E A R | T E N S I L E | Dome Head | Large Flange | Countsk. Head | S H E A R | T E N S I L E | Dome Head | Large Flange | Countsk. Head | S H E A R | T E N S I L E |
| 3/32 (2.4mm) | .020-.125 0.8-3.2mm | .250 6.4mm | 32AAP | - | 32AAC | 70 | 80 | 32ASP | - | 32ASC | 90 | 120 | 32SSP | - | 32SSC | 130 | 170 |
| | .126-.250 3.3-6.4mm | .375 9.5mm | 34AAP | - | 34AAC | | | 34ASP | - | 34ASC | | | 34SSP | - | 34SSC | | |
| | .251-.375 6.5-9.5mm | .500 12.7mm | 36AAP | - | 36AAC | | | 36ASP | - | 36ASC | | | 36SSP | - | 36SSC | | |
| 1/8 (3.2mm) | .020-.062 0.8-1.6mm | .212 5.4mm | 41AAP | - | - | 120 | 150 | 41ASP | - | 41ASC | 170 | 220 | 41SSP | - | 41SSC | 260 | 310 |
| | .063-.125 1.7-3.2mm | .275 7.0mm | 42AAP | 42AAL | 34AAC | | | 42ASP | 42ASL | 42ASC | | | 42SSP | 42SSL | 42SSC | | |
| | .126-.187 3.3-4.8mm | .337 8.6mm | 43AAP | - | 43AAC | | | 43ASP | - | 43ASC | | | 43SSP | - | 43SSC | | |
| | .188-.250 4.9-6.4mm | .400 10.2mm | 44AAP | 44AAL | 44AAC | | | 44ASP | 44ASL | 44ASC | | | 44SSP | 44SSL | 44SSC | | |
| | .251-.312 6.5-7.9mm | .462 11.7mm | 45AAP | - | 45AAC | | | 45ASP | - | 45ASC | | | 45SSP | - | 45SSC | | |
| | .313-.375 8.0-9.5mm | .525 13.4mm | 46AAP | 46AAL | 46AAC | | | 46ASP | 46ASL | 46ASC | | | 46SSP | 46SSL | 46SSC | | |
| | .376-.500 9.6-12.7mm | .650 16.5mm | 48AAP | 48AAL | 48AAC | | | 48ASP | 48ASL | 48ASC | | | 48SSP | 48SSL | 48SSC | | |
| | .501-.625 12.8-15.9mm | .775 19.7mm | 410AAP | - | 410AAC | | | 410ASP | - | 410ASC | | | 410SSP | 410SSL | 410SSC | | |
| 5/32 (4.0mm) | .020-.125 1.6-3.2mm | .300 7.6mm | 52AAP | - | - | 190 | 230 | 52ASP | - | 52ASC | 260 | 350 | 52SSP | - | - | 370 | 470 |
| | .063-.125 1.7-3.2mm | .275 7.0mm | 53AAP | - | - | | | 53ASP | - | - | | | 53SSP | - | - | | |
| | .126-.187 3.3-4.8mm | .337 8.6mm | 54AAP | 54AAL | 54AAC | | | 54ASP | 54ASL | 54ASC | | | 54SSP | 54SSL | 54SSC | | |
| | .188-.250 4.9-6.4mm | .400 10.2mm | 56AAP | 56AAL | 56AAC | | | 56ASP | 56ASL | 56ASC | | | 56SSP | 56SSL | 56SSC | | |
| | .251-.312 6.5-7.9mm | .462 11.7mm | 58AAP | 58AAL | 58AAC | | | 58ASP | 58ASL | 58ASC | | | 58SSP | 58SSL | 58SSC | | |
| | .313-.375 8.0-9.5mm | .525 13.4mm | 510AAP | - | 510AAC | | | 510ASP | - | 510ASC | | | 510SSP | - | 510SSC | | |

* ALL PART NUMBERS PRECEDED WITH PR., EXAMPLE PR44SSP

** SPECIALS AVAILABLE UPON REQUEST



BLIND RIVETS – OPEN END

| Rivet Diameter | G Grip Range | L Rivet Lengths Max | Aluminum Rivet Aluminum Mandrel IFI Grade 11 | | | | Aluminum Rivet Steel Mandrel IFI Grade 19 | | | | Steel Rivet Steel Mandrel IFI Grade 30 | | | | | | |
|-----------------|---------------------------|---------------------|--|--------------|---------------|-----------|---|-----------|--------------|---------------|--|---------------|-----------|--------------|---------------|-----------|---------------|
| | | | Dome Head | Large Flange | Countsk. Head | S H E A R | T E N S I L E | Dome Head | Large Flange | Countsk. Head | S H E A R | T E N S I L E | Dome Head | Large Flange | Countsk. Head | S H E A R | T E N S I L E |
| 3/16 (4.8mm) | .020-.125 1.6-3.2mm | .325 8.3mm | 62AAP | - | - | 260 | 320 | 62ASP | - | - | 380 | 500 | 62SSP | - | - | 540 | 680 |
| | .125-.250 3.2-6.4mm | .450 11.5mm | 64AAP | 64AAL | 64AAC | | | 64ASP | 64ASL | 64ASC | | | 64SSP | 64SSL | 64SSC | | |
| | .251-.375 6.5-9.5mm | .575 14.6mm | 66AAP | 66AAL | 66AAC | | | 66ASP | 66ASL | 66ASC | | | 66SSP | 66SSL | 66SSC | | |
| | .376-.500 9.6-12.7mm | .700 17.8mm | 68AAP | 68AAL | 68AAC | | | 68ASP | 68ASL | 68ASC | | | 68SSP | 68SSL | 68SSC | | |
| | .501-.625 12.8-15.9mm | .825 21.0mm | 610AAP | 610AAL | 610AAC | | | 610ASP | 610ASL | 610ASC | | | 610SSP | 610SSL | 610SSC | | |
| | .626-.750 16.0-19.1mm | .950 24.2mm | 612AAP | 612AAL | 612AAC | | | 612ASP | 612ASL | 612ASC | | | 612SSP | 612SSL | 612SSC | | |
| | .751-.875 19.1-22.2mm | 1.075 27.3mm | 614AAP | 614AAL | 614AAC | | | 614ASP | 614ASL | 614ASC | | | 614SSP | 614SSL | 614SSC | | |
| | .876-1.000 22.3-25.4mm | 1.200 30.5mm | 616AAP | - | 616AAC | | | 616ASP | - | 616ASC | | | 616SSP | - | 616SSC | | |
| 1/4 (6.4mm) | .020-.125 1.6-3.2mm | .375 9.5mm | 82AAP | - | - | 460 | 560 | 82ASP | - | - | 700 | 920 | 82SSP | - | - | 1000 | 1240 |
| | .126-.250 3.3-6.4mm | .500 12.7mm | 84AAP | 84AAL | 84AAC | | | 84ASP | 84ASL | 84ASC | | | 84SSP | 84SSL | 84SSC | | |
| | .251-.375 6.5-9.5mm | .625 15.9mm | 86AAP | 86AAL | 86AAC | | | 86ASP | 86ASL | 86ASC | | | 86SSP | 86SSL | 86SSC | | |
| | .376-.500 9.6-12.7mm | .750 19.1mm | 88AAP | 88AAL | 88AAC | | | 88ASP | 88ASL | 88ASC | | | 88SSP | 88SSL | 88SSC | | |
| | .501-.625 12.8-15.9mm | .875 21.0mm | 810AAP | 810AAL | 810AAC | | | 810ASP | 810ASL | 810ASC | | | 810SSP | 810SSL | 810SSC | | |
| | .626-.750 16.0-19.1mm | 1.000 25.4mm | 812AAP | 812AAL | 812AAC | | | 812ASP | 812ASL | 812ASC | | | 812SSP | 812SSL | 812SSC | | |
| | .751-.875 19.1-22.2mm | 1.125 28.6mm | 814AAP | 814AAL | 814AAC | | | 814ASP | 814ASL | 814ASC | | | 814SSP | 814SSL | 814SSC | | |
| | .876-1.000 22.3-25.4mm | 1.250 31.8mm | 816AAP | 816AAL | 816AAC | | | 816ASP | 816ASL | 816ASC | | | 816SSP | 816SSL | 816SSC | | |



BLIND RIVETS - OPEN END

| Rivet Diameter | G Grip Range | L Rivet Lengths Max | Stainless Rivet Stainless Mandrel IFI Grade 51 | | | | | Stainless Rivet Steel Mandrel IFI Grade 50 | | | | | Copper Rivet Steel Mandrel IFI Grade 20 | | | | |
|-----------------|--------------------------|---------------------|---|--------------|--------------|-------|---------|---|--------------|--------------|-------|---------|--|--------------|--------------|-------|---------|
| | | | Dome Head | Large Flange | Counts. Head | SHEAR | TENSILE | Dome Head | Large Flange | Counts. Head | SHEAR | TENSILE | Dome Head | Large Flange | Counts. Head | SHEAR | TENSILE |
| 3/32 (2.4mm) | .020-.125 0.8-3.2mm | .250 6.4mm | 32FFP | - | 32FFC | 230 | 280 | 32FSP | - | 32FSC | 230 | 280 | - | - | - | | |
| | .126-.250 3.3-6.4mm | .375 9.5mm | 34FFP | - | 34FFC | | | 34FSP | - | 34FSC | | | - | - | - | | |
| 1/8 (3.2mm) | .020-.062 0.8-1.6mm | .212 5.4mm | 41FFP | - | - | 420 | 530 | 41FSP | - | - | 420 | 530 | 41CSP | - | - | 215 | 300 |
| | .063-.125 1.7-3.2mm | .275 7.0mm | 42FFP | 42FFL | 42FFC | | | 42FSP | 42FSL | 42FSC | | | 42CSP | 42CSL | 42CSC | | |
| | .126-.187 3.3-4.8mm | .337 8.6mm | 43FFP | 43FFL | 43FFC | | | 43FSP | 43FSL | 43FSC | | | 43CSP | - | 43CSC | | |
| | .188-.250 4.9-6.4mm | .400 10.2mm | 44FFP | 44FFL | 44FFC | | | 44FSP | 44FSL | 44FSC | | | 44CSP | 44CSL | 44CSC | | |
| | .251-.312 6.5-7.9mm | .462 11.7mm | 45FFP | - | 45FFC | | | 45FSP | - | 45FSC | | | 45CSP | - | 45CSC | | |
| | .313-.375 8.0-9.5mm | .525 13.4mm | 46FFP | 46FFL | 46FFC | | | 46FSP | 46FSL | 46FSC | | | 46CSP | 46CSL | - | | |
| | .376-.500 9.6-12.7mm | .650 16.5mm | 48FFP | 48FFL | - | | | 48FSP | - | - | | | 48CSP | 48CSL | 48CSC | | |
| | .501-.625 12.8-15.9mm | .775 19.7mm | 410FFP | - | - | | | 410FSP | - | - | | | 410CSP | - | 410CSC | | |
| 5/32 (4.0mm) | .020-.125 1.6-3.2mm | .300 7.6mm | 52FFP | - | - | 650 | 820 | - | - | - | 650 | 820 | - | - | - | | |
| | .126-.187 3.3-4.8mm | .337 8.6mm | 53FFP | - | - | | | - | - | - | | | - | - | | | |
| | .188-.250 4.9-6.4mm | .400 10.2mm | 54FFP | 54FFL | 54FFC | | | 54FSP | 54FSL | 54FSC | | | - | - | - | | |
| | .313-.375 8.0-9.5mm | .525 13.4mm | 56FFP | 56FFL | 56FFC | | | 56FSP | 56FSL | 56FSC | | | - | - | - | | |
| 3/16 (4.8mm) | .020-.125 1.6-3.2mm | .325 8.3mm | 62FFP | - | - | 950 | 1200 | 62FSP | - | - | 950 | 1200 | - | - | - | | |
| | .125-.250 3.2-6.4mm | .450 11.5mm | 64FFP | 64FFL | 64FFC | | | 64FSP | 64FSL | 64FSC | | | - | - | - | | |
| | .251-.375 6.5-9.5mm | .575 14.6mm | 66FFP | 66FFL | 66FFC | | | 66FSP | 66FSL | 66FSC | | | - | - | - | | |
| | .376-.500 9.6-12.7mm | .700 17.8mm | 68FFP | 68FFL | 68FFC | | | 68FSP | 68FSL | 68FSC | | | - | - | - | | |
| | .501-.625 12.8-15.9mm | .825 21.0mm | 610FFP | 610FFL | - | | | - | - | - | | | - | - | - | | |
| | .626-.750 16.0-19.1mm | .950 24.2mm | 612FFP | 612FFL | - | | | 612FSP | 612FSL | - | | | - | - | - | | |
| | .751-.875 19.1-22.2mm | 1.075 27.3mm | 614FFP | 614FFL | - | | | - | - | - | | | - | - | - | | |
| | .876-1.00 22.3-25.4mm | 1.200 30.5mm | 616FFP | 616FFL | - | | | - | - | - | | | - | - | - | | |
| 1/4 (6.4mm) | .020-.125 1.6-3.2mm | .375 9.5mm | 82FFP | - | - | 1700 | 2100 | 82FSP | - | - | 1700 | 2100 | - | - | - | | |
| | .126-.250 3.3-6.4mm | .500 12.7mm | 84FFP | - | 84FFC | | | 84FSP | - | 84FSC | | | - | - | | | |
| | .251-.375 6.5-9.5mm | .625 15.9mm | 86FFP | - | 86FFC | | | 86FSP | - | 86FSC | | | - | - | | | |
| | .376-.500 9.6-12.7mm | .750 19.1mm | 88FFP | - | 88FFC | | | 88FSP | - | 88FSC | | | - | - | | | |
| | .501-.625 12.8-15.9mm | .875 21.0mm | 810FFP | - | 810FFC | | | 810FSP | - | 810FSC | | | - | - | | | |



CLOSED END BLIND RIVETS - DOME HEAD

Dimensions of Dome Head Style Break Mandrel Closed end Blind Rivets (Table 1)

| Rivet Series NO. | Nom Rivet Size | D | | H | | E | R | W | P | F | L |
|------------------|----------------|----------|-------|----------------------|---------------|-------------|------------------|-------------|--------------------|-----------------------------|-------------------|
| | | Body Dia | | Style 1 Regular Head | | Head Height | Radius of Fillet | Mandrel Dia | Mandrel Protrusion | Blind Side Protrusion | Rivet Body Length |
| | | Max | Min | Head Dia | All Materials | | | Max | | | |
| 4 | 1/8 0.1250 | 0.128 | 0.122 | 0.252 | 0.224 | 0.050 | 0.025 | 0.074 | 1.00 | Equal "L" Rivet Body Length | See Table 2 |
| 5 | 5/32 0.1562 | 0.159 | 0.153 | 0.328 | 0.296 | 0.065 | 0.025 | 0.092 | 1.06 | | |
| 6 | 3/16 0.1875 | 0.191 | 0.183 | 0.394 | 0.356 | 0.080 | 0.025 | 0.110 | 1.06 | | |
| 8 | 1/4 0.2500 | 0.255 | 0.246 | 0.525 | 0.475 | 0.100 | 0.025 | 0.146 | 1.06 | | |
| See Notes | | | | | | | 3 | | | 4 | |

Notes:

* All Dimensions are in inches.

* Recommended drill sizes are those which normally produce holes within the specified hole size limits.

Dome Head Closed-End Blind Rivets

PR-AAPH (Aluminum Rivet / Aluminum Mandrel)

PR-ASPH (Aluminum Rivet / Steel Mandrel)

PR-FFPH (Stainless Steel Rivet / Stainless Steel Mandrel)

Example: **PR64FFPH**

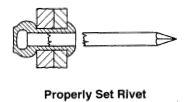
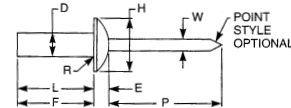

Dome Head

| Rivet Series NO. | Nom Rivet Size | Recommended Drill Size | Recommended Hole Size | | Rivet No. | Grip Range | Rivet Body Length |
|------------------|----------------|------------------------|-----------------------|-------|-----------|------------|-------------------|
| | | | Max | Min | | | Max |
| 4 | 1/8 0.1250 | #30 | 0.133 | 0.129 | 41 | .020-.062 | 0.297 |
| | | | | | 42 | .063-.125 | 0.360 |
| | | | | | 43 | .126-.187 | 0.422 |
| | | | | | 44 | .188-.250 | 0.485 |
| | | | | | 45 | .251-.312 | 0.547 |
| 5 | 5/32 0.1562 | #20 | 0.164 | 0.160 | 46 | .313-.375 | 0.610 |
| | | | | | 47 | .376-.500 | 0.735 |
| | | | | | 52 | .020-.125 | 0.375 |
| | | | | | 53 | .126-.187 | 0.437 |
| | | | | | 54 | .188-.250 | 0.500 |
| 6 | 3/16 0.1875 | #11 | 0.196 | 0.192 | 55 | .251-.312 | 0.562 |
| | | | | | 56 | .313-.375 | 0.625 |
| | | | | | 57 | .376-.500 | 0.750 |
| | | | | | 62 | .020-.125 | 0.406 |
| | | | | | 64 | .126-.250 | 0.531 |
| 8 | 1/4 0.2500 | F | 0.261 | 0.257 | 66 | .251-.375 | 0.656 |
| | | | | | 68 | .376-.500 | 0.781 |
| | | | | | 610 | .501-.625 | 0.906 |
| | | | | | 612 | .626-.750 | 1.026 |
| | | | | | 82 | .020-.125 | 0.445 |
| | | | | | 84 | .126-.250 | 0.570 |
| | | | | | 86 | .251-.375 | 0.695 |
| 8 | 1/4 0.2500 | F | 0.261 | 0.257 | 88 | .376-.500 | 0.820 |
| | | | | | 810 | .501-.625 | 0.945 |
| | | | | | 812 | .626-.750 | 1.070 |
| | | | | | 814 | .751-.875 | 1.195 |
| 816 | .876-1.00 | 1.320 | | | | | |
| See Notes | 2 | | | | | | |

Notes:

* All Dimensions are in inches.

* For application data, see table 2

* The Junction of head shank shall have a fillet with a max radius as shown.

* The blind side protrusion (F) equals the max length of rivet body (L) as given in Table 2 for the applicable grip. Minimum blind side clearance may be calculated by subtracting the actual grip (G) (i.e. the total thickness of material to be joined) from the blind side protrusion (F). (Example: To join two plates each .100 in. thick with a 5/32 in. rivet, a No. 54 rivet would be used. Minimum blind side clearance necessary to permit proper rivet setting would be L-G, which is .500 - .200 and equals .300 in.)



CLOSED END BLIND RIVETS - 120° COUNTERSUNK HEAD

Closed-End Blind Rivets Countersunk Head Specifications

| Rivet Series NO. | Nom Rivet Size | D | | H | | E | R | W | P | F | L |
|------------------|----------------|----------|-------|----------------------|-------|-------------|------------------|---------------|--------------------|-----------------------------|-------------------|
| | | Body Dia | | Style 1 Regular Head | | | Radius of Fillet | Mandrel Dia | Mandrel Protrusion | Blind Side Protrusion | Rivet Body Length |
| | | | | Head Dia | | Head Height | | All Materials | | | |
| | | Max | Min | Max | Min | Max | Max | Min | Max | | |
| 4 | 1/8 0.1250 | 0.128 | 0.122 | 0.252 | 0.221 | 0.0420 | 0.025 | 0.074 | 1.00 | Equal "L" Rivet Body Length | See Table 2 |
| 5 | 5/32 0.1562 | 0.159 | 0.153 | 0.328 | 0.296 | 0.051 | 0.025 | 0.092 | 1.06 | | |
| 6 | 3/16 0.1875 | 0.191 | 0.183 | 0.394 | 0.356 | 0.060 | 0.025 | 0.110 | 1.06 | | |
| 8 | 1/4 0.2500 | 0.255 | 0.246 | 0.525 | 0.475 | 0.080 | 0.025 | 0.146 | 1.06 | | |
| See Notes | | | | 3 | | 4 | | | | 5 | |

Notes:

- * All Dimensions are in inches.
- * Recommended drill sizes are those which normally produce holes within the specified hole size limits.

Countersunk Head Closed-End Blind Rivets

- PR-AAACH** (Aluminum Rivet / Aluminum Mandrel)
 - PR-ASCH** (Aluminum Rivet / Steel Mandrel)
 - PR-FFCH** (Stainless Steel Rivet / Stainless Steel Mandrel)
- Example: **PR64FFCH**

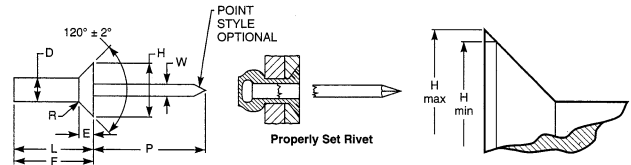

120° Countersunk Head

| Rivet Series NO. | Nom Rivet Size | Recommended Drill Size | Recommended Hole Size | | Rivet No. | Grip Range | Rivet Body Length |
|------------------|----------------|------------------------|-----------------------|-------|-----------|------------|-------------------|
| | | | Max | Min | | | Max |
| 4 | 1/8 0.1250 | #30 | 0.133 | 0.129 | 41 | .031-.062 | 0.332 |
| | | | | | 42 | .063-.125 | 0.395 |
| | | | | | 43 | .126-.187 | 0.457 |
| | | | | | 44 | .188-.250 | 0.520 |
| | | | | | 45 | .251-.312 | 0.582 |
| 5 | 5/32 0.1562 | #20 | 0.164 | 0.160 | 46 | .313-.375 | 0.645 |
| | | | | | 47 | .376-.500 | 0.770 |
| | | | | | 48 | .376-.500 | 0.770 |
| | | | | | 52 | .063-.125 | 0.425 |
| | | | | | 53 | .126-.187 | 0.487 |
| 6 | 3/16 0.1875 | #11 | 0.196 | 0.192 | 54 | .188-.250 | 0.550 |
| | | | | | 55 | .251-.312 | 0.612 |
| | | | | | 56 | .313-.375 | 0.675 |
| | | | | | 57 | .376-.500 | 0.800 |
| | | | | | 58 | .376-.500 | 0.800 |
| 8 | 1/4 0.2500 | F | 0.261 | 0.257 | 59 | .063-.125 | 0.471 |
| | | | | | 60 | .126-.250 | 0.601 |
| | | | | | 61 | .251-.375 | 0.736 |
| | | | | | 62 | .376-.500 | 0.851 |
| | | | | | 63 | .501-.625 | 1.026 |
| See Notes | | 2 | | | 64 | .626-.750 | 1.101 |
| | | | | | 65 | .020-.125 | 0.525 |
| | | | | | 66 | .126-.250 | 0.650 |
| | | | | | 67 | .251-.375 | 0.775 |
| | | | | | 68 | .376-.500 | 0.900 |
| | | | | | 69 | .501-.625 | 1.025 |
| | | | | | 70 | .626-.750 | 1.150 |
| | | | | | 71 | .751-.875 | 1.275 |
| | | | | | 72 | .876-1.00 | 1.400 |
| | | | | | 73 | .876-1.00 | 1.400 |

Notes:

- * All Dimensions are in inches.
- * For application data, see table 2
- * Maximum head diameter is called on nominal rivet diameter and nominal head angle extended to sharp corner. Minimum head diameter is absolute
- * Head Height is given for reference purposes only. Variations in this dimension are controlled by the diameters (H) and (D) and the included angle of the head.
- * The blind side protrusion (F) equals the max length of rivet body (L) as given in Table 2 for the applicable grip. Minimum blind side clearance may be calculated by subtracting the actual grip (G) (i.e. the total thickness of material to be joined) from the blind side protrusion (F). (Example: To join two plates each .100 in. thick with a 5/32 in. rivet, a No. 54 rivet would be used. Minimum blind side clearance necessary to permit proper rivet setting would be L-G, which is .550 - .200 and equals .350 in.)